

FINISHING: Cut batting and backing 3" larger than top on all sides. Layer backing, batting and top together and baste or pin. When quilting is completed, trim excess batting and backing. Bind as usual.

QUILT DIAGRAM

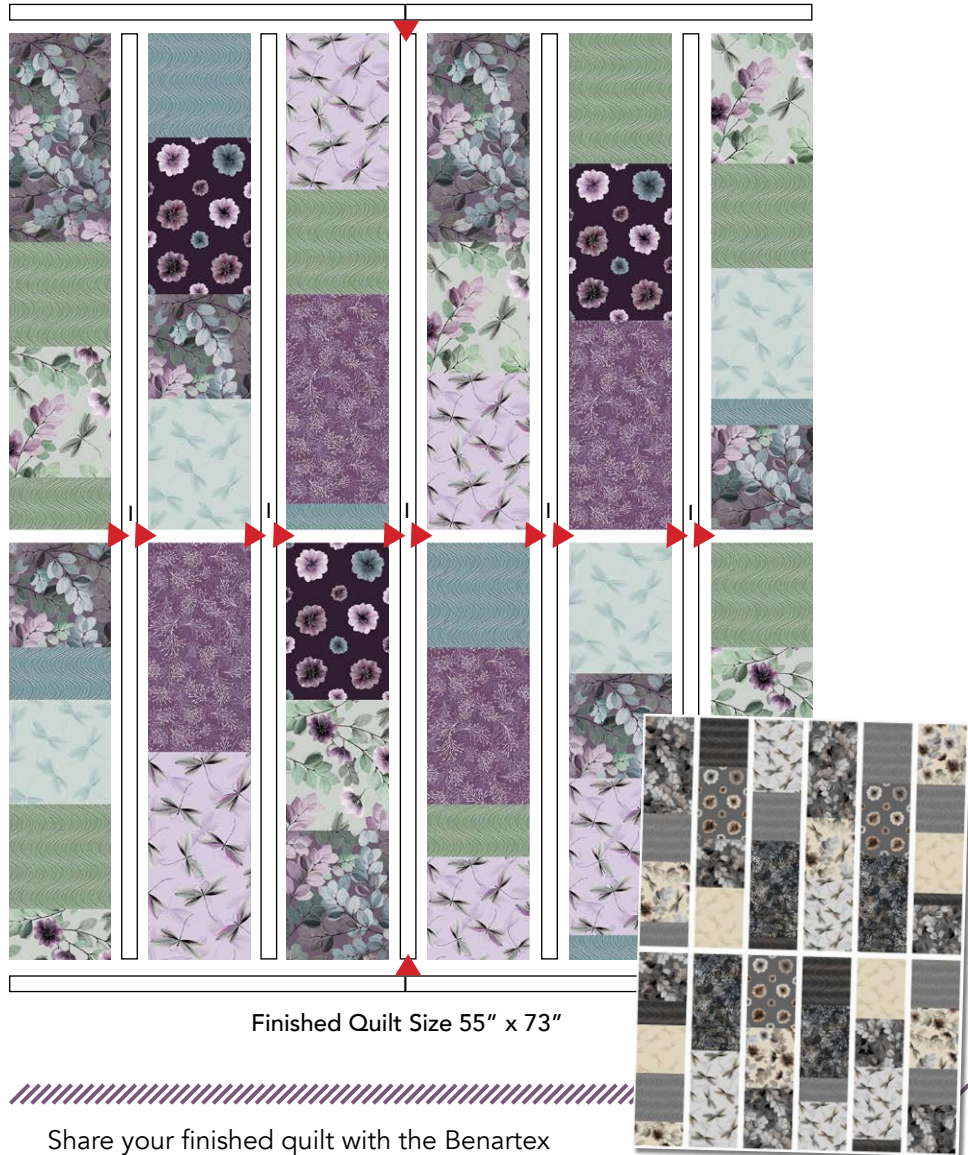

Share your finished quilt with the Benartex community on social media by tagging **#benartex_fabrics!**



Note: If this Benartex pattern is included in a kit, any questions about the kit should be addressed to the vendor from whom you bought it.

Shimmer & Stripes

By Benartex Studios









Delicate dragonflies, beautiful blooms and rich textures, touched with pearl accents, makes a truly lovely collection. Two outstanding color-ways are the designers final touch.

Enhanced with Pearlescent
ESSENCE OF PEARL
By Kanvas Studio

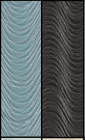
Finished Size
55" x 73"

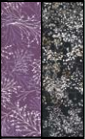
KANVAS
STUDIO

SAMPLE	KEY/SKU	QTY	CUT
	A Sheer Leaves 8727P-62 Lavender 8727P-11 Smokey Gray	3/4 yd	(3) 8½" x WOF strips, subcut (5) 8½" squares (2) 8½" x 16½" rectangles (1) 8½" x 10½" rectangles
	B Wind Wave 8728P-40 Sage 8728P-13 Steel	1/2 yd	(2) 8½" x WOF strips, subcut (1) 8½" x 6½" rectangles (1) 8½" x 10½" rectangles (2) 8½" x 4½" rectangles (5) 8½" squares
	C Tree Blossoms 8726P-06 Lavender 8726P-07 Ecru	1/2 yd	(2) 8½" x WOF strips, subcut (5) 8½" x 10½" rectangles (1) 8½" x 4½" rectangles
	D Wind Wave 8728P-54 Seafoam 8728P-11 Charcoal	1/4 yd	(1) 8½" x WOF strips, subcut (2) 8½" squares (3) 8½" x 2½" strips (1) 8½" x 4½" rectangles
	E Dragonfly Silhouette 8731P-04 Light Sage 8731P-07 Ecru	1/2 yd	(2) 8½" x WOF strips, subcut (1) 8½" squares (3) 8½" x 10½" rectangles
	F Floating Blossoms 8729P-66 Purple 8729P-11 Stone Gray	1/4 yd	(1) 8½" x WOF strips, subcut (3) 8½" x 12½" rectangles
	G Tossed Sprigs 8733P-62 Purple Queen Anns Lace 8730P-12 Black	1/2 yd	(2) 8½" x WOF strips, subcut (3) 8½" x 16½" rectangles (1) 8½" x 12½" rectangles
	H Dragonfly Dream 8732P-06 Lilac 8732P-13 Dove	1/2 yd	(2) 8½" x WOF strips, subcut (3) 8½" x 12½" rectangles (1) 8½" x 16½" rectangles (1) 8½" square
	I Colors For Quilters 3000H-09 White	1-3/8 yd	(2) 1 ½" x WOF strips, subcut (6) 1 ½" x 8 ½" rectangles (16) 1 ½" x WOF strips*, sashing & borders (7) 2 ¼" x WOF strips*, Binding

 TEXT IN PURPLE REPRESENTS PURPLE COLOR-WAY

WOF = WIDTH OF FABRIC | *SEW STRIPS VIA SHORT ENDS

1. Quilt Center

Sew together quilt using **A-H** 8-1/2" squares and rectangles following the diagram below. Sew (1) **I** 1-1/2" x 8-1/2" sashing strip in between each row as shown in diagram.

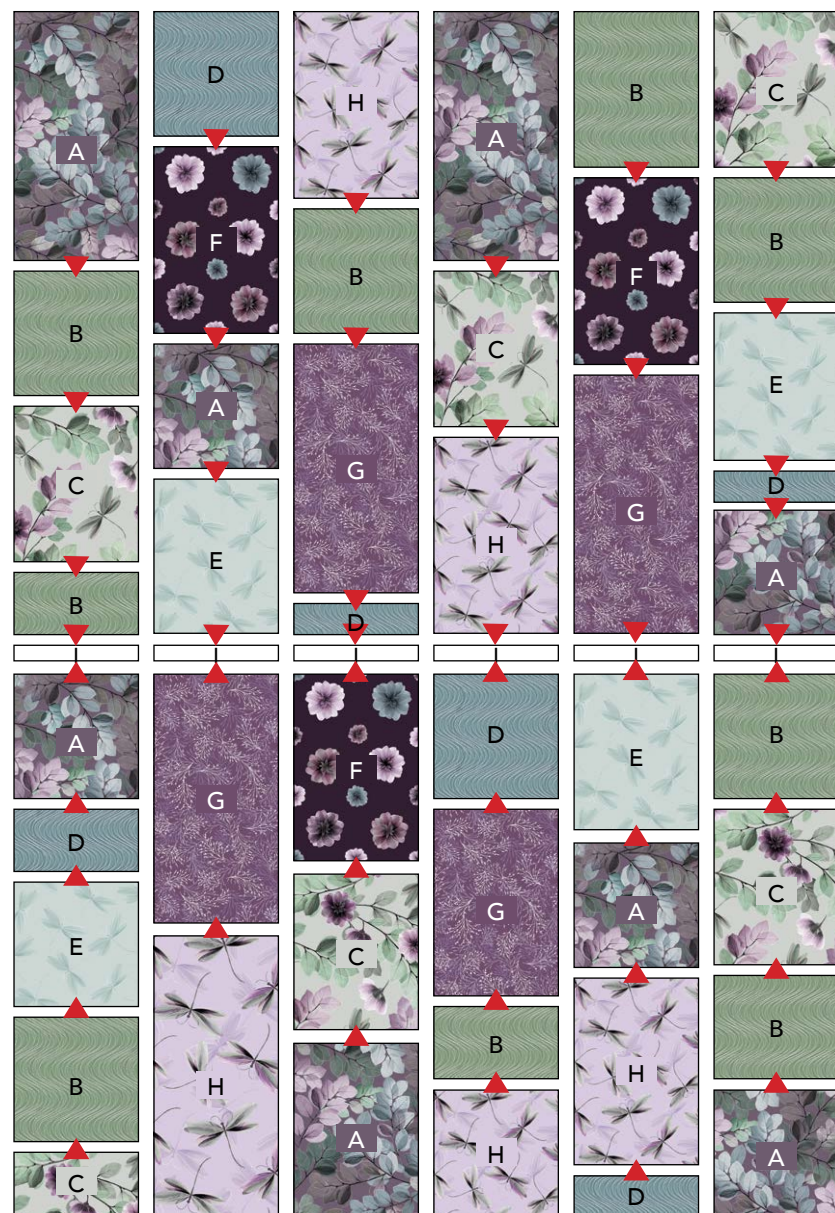

2. Sashing & Borders: Following the Quilt Diagram on the last page, sew (1) **I** 1 ½" x 71 ½" strip in-between each row and (1) to left side and (1) to the right side of **QUILT CENTER**. Then sew (1) **I** 1 ½" x 55 ½" strip to the top and bottom of **QUILT CENTER**.